

Touch PRO

Carwash multi-device

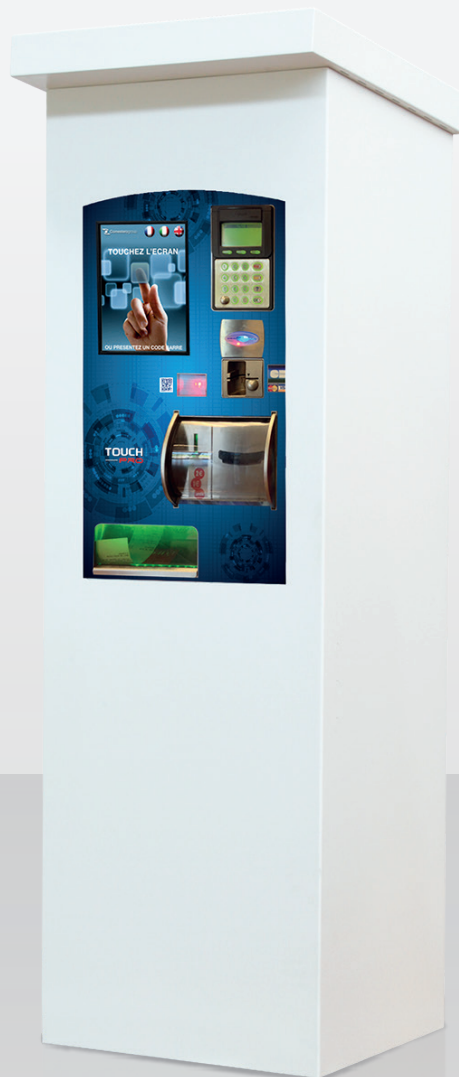

A truly automated car wash service support and a powerful marketing tool

Automated Support Service and Effective Marketing Tool

Touch PRO is a revolutionary multi-device for car wash facilities. Equipped with state-of-the-art technology, it offers numerous advantages to both users and operators. Touch PRO is not just a simple centralised cash point but also an automated support service and a powerful marketing tool which allows the operator to increase the business. It manages up to 8 different services and dispense complementary products, such as tokens and cards.

Features

- User friendly touch screen interface for easy sales operations as well as accounting data configuration and collection
- Graphic and vocal support to guide customer through various operations
- Payment in coins, banknotes, tokens, cards/keys and bankcards (optional)
- Change is given
- Dispense keys, cards and tokens
- Management of promotional campaigns based on discounts and special offers
- Incentive to stimulate users to purchase higher price/quality programs
- Printing of limited-time promotional tickets to increase customer visit frequency
- Barcode scanning to manage promotions, bonuses and discounts
- Differentiated pricing per payment method (cash or cashless)
- Automatic alarms email
- Automatic accounting email
- Printing of daily accounting reports by means of a special barcode
- Exporting of accounting data in .csv format
- Receipt in case of malfunction and service delivery failure

Installed Peripherals

- Anti-vandal touch screen
- RM5 HD coin validator
- Barcode scanner
- Thermal receipt printer

Optional peripheral devices

- NV9 USB+ banknote reader
- Evolution Hopper
- 2nd Evolution Hopper
- EuroKey Next cashless system
- Card dispenser
- Key dispenser
- Credit and debit bankcard reader
- Easy Pay to activate washing program via QR code
- Direct phone calls through a dedicated line

Tools

TouchConfig

Integrated program for device configuration. It allows to import and export total and partial accounting data.

TouchCompta

Program for consulting, analysing, exporting and printing the accounting data. It allows to set the search filters to get the statistics of marketing operations. Data access is protected by hierarchical passwords.

Optional Accessories

- 'Accessible' cabinet
- Standard cabinet

Technical Schematics

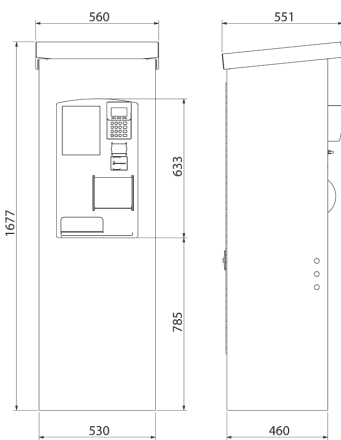

Note: Unit of measure mm

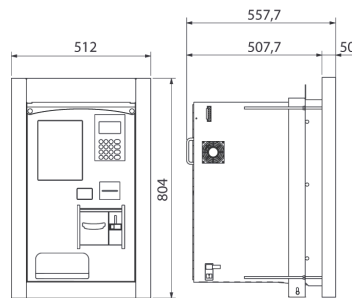

Technical Specifications

	Accessible cabinet-mounted	Wall-mounted
Dimensions (LxHxD)	560 x 1.677 x 551 mm	512 x 804 x 562,7 mm
Weight	81 Kg	53 Kg
Supply voltage	230 Vac	230 Vac
Current consumption	230 VA	230 VA
Operating temperature	-15 °C to 50 °C humidity 10% - 90% uncondensed	-15 °C to 50 °C humidity 10% - 90% uncondensed

Internet connection required to make the machine work properly

Coin Capacity

	0.50 €	1,00 €	2,00 €
1 Evolution hopper	1,500	1,500	1,200
2 Evolution hopper	3,000	3,000	2,400